

# Energy Savings

## Brackish Water Reverse Osmosis (RO) Element

### LG BW 440 ES



### Overview

LG Chem's NanoH<sub>2</sub>O™ brackish water RO membranes lower water treatment costs by improving energy efficiency and productivity. These thin-film nanocomposite (TFN) membranes feature benign nanomaterials incorporated into the thin-film polyamide layer of a composite membrane. This innovative patented and patent-pending technology significantly increases membrane permeability while matching best-in-class salt rejection.

- Superior flux and high salt rejection
- Ideal for low energy applications
- Easy to retrofit existing RO plants



### Product Specifications

Configuration: 8-inch spiral wound  
 Membrane Polymer: Thin-film nanocomposite (TFN) polyamide

Product Number	Permeate flow rate m <sup>3</sup> /d (gpd)	Minimum NaCl Rejection %	Stabilized NaCl Rejection %	Active Membrane Area m <sup>2</sup> (ft <sup>2</sup> )	Feed Spacer mil
LG BW 440 ES	43.7 (11,550)	99.5	99.6	41 (440)	28

Note: The above values are normalized to the following conditions: 2,000 ppm NaCl, 10.3 bar (150 psi), 25°C (77°F), pH 8, 15% recovery. Permeate flows for individual elements may vary +/- 15%.

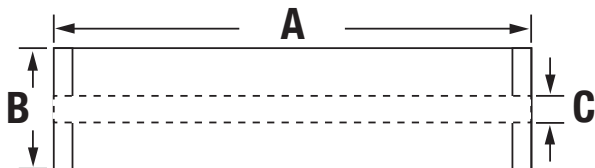

Part Number	Length A	Element O.D. B	Perm Tube I.D. C	Weight kg (lbs.)
LG BW 440 ES	1016 mm (40 in.)	200 mm (7.9 in.)	28.6 mm (1.125 in.)	16.4 (36)

### Operating Specifications

For more information and operating guidelines, visit [www.LGwatersolutions.com](http://www.LGwatersolutions.com)

Max. Operating Pressure:	41 bar (600 psig)
Max. Chlorine Concentration:	< 0.1 ppm
Max. Operating Temperature:	45°C (113°F)
pH Range, Continuous (Cleaning):	2-11 (2-12)
Max. Feedwater Turbidity:	1.0 NTU
Max. Feedwater SDI (15 mins):	5.0
Max. Feed Flow:	19 m <sup>3</sup> /h (85 GPM)
Max. Pressure Drop:	1.0 bar (15 psig)

The information and data contained herein are deemed to be accurate and reliable and are offered in good faith, but without guarantee of performance. LG NanoH<sub>2</sub>O assumes no liability for results obtained or damages incurred through the application of the information contained herein. Customer is responsible for determining whether the products and information presented herein are appropriate for the customer's use and for ensuring that customer's workplace and disposal practices are in compliance with applicable laws and other governmental enactments. Specifications subject to change without notice. NanoH<sub>2</sub>O is a trademark of LG Chem. LG Water Solutions is part of LG Chem, Ltd. All rights reserved. © 2016 LG Chem.



Serin Industrieanlagen  
 Schallbruch 8 • 42781 Haan • Germany  
 T: +49 2129 3321478 • F: +49 2129 3321476 • E: [info@serin-industrieanlagen.de](mailto:info@serin-industrieanlagen.de)  
[www.serin-industrieanlagen.com](http://www.serin-industrieanlagen.com)

Rev. B (08.15)